

Solid top cover with T-frames

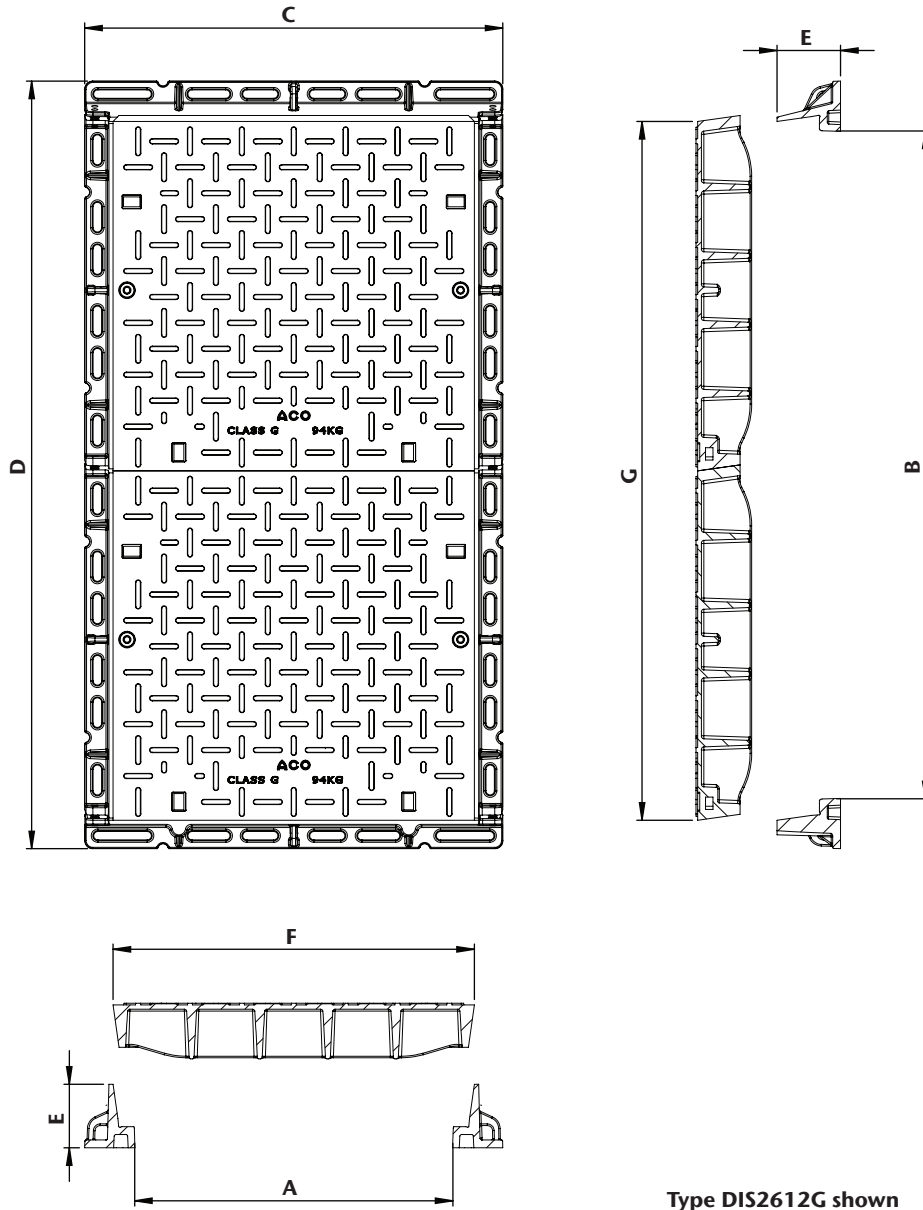

Type DIS2612G shown

Product Table

Type	Part No.	Clear Opening Width (A)	Clear Opening Length (B)	Overall Width (C)	Overall Length (D)	Overall Depth (E)	Cover Width (F)	Cover Length (G)	Cover Weight (kg)	Overall Weight (kg)
DIS2612G	143246	600	1260	790	1450	120	680	1320	95/95	279
DIS2715G	143251	750	1560	940	1750	120	830	1620	143/143	393
DIS2918G	143258	900	1860	1090	2050	120	980	1920	217/217	559

Notes:

1. All dimensions in the table are nominal and are shown in millimeters.
2. Bolts are standard for each cover, specify Standard Locking bolts (SL) or security rated Security Bolts (SB) after part no.
3. If structural locking bolts are required, contact ACO.

ACO Specification Information

ACO ACCESS

Rhinocast - 2-part solid top iron access cover with T-frames - Class G

Accessories

Part No.	Description	Weight (kg)
84654	Rhinocast short handle lifters (pair)	3.60
84854	Rhinocast long handle lifters (pair)	8.10
73131	Sealing grease	4.40
84620	Rectangular red caps (short) for lifting key holes	-
84626	Circular red caps for locking bolt holes	-
77416	Brass plate (75 x 75mm) marked 'ELECTRICITY'	0.05
77402	Brass plate (75 x 75mm) marked 'COMMUNICATIONS'	0.05
77420	Brass plate (75 x 75mm) marked 'GAS'	0.05

Specifications

General

The access covers and frames shall be ACO Rhinocast solid top access covers with T-frames as manufactured by ACO Pty Ltd. or equal approved.

Materials

The Rhinocast solid top access covers and T-frames shall be manufactured from ductile iron (spheroidal graphite cast iron) to the requirements of AS 3996 with:

Minimum tensile strength: 600MPa
Minimum elongation: 3%

The cover and frames shall be coated with a black water based paint for short term protection only.

Cover

The Rhinocast solid top covers shall have the following features to AS 3996 requirements:

Load Class	G (900kN)
Watertight & Gas-tight	Sealed
Internal Pressure Resistance	IPD
Slip Resistance	P5
Permanent Markings	
Lifting Keyholes	

Rhinocast covers are locked down as standard with two stainless steel M12x100 socket head bolts.

Optional, specify if required:

For a more secure cover, specify 'SB' after part number for tamper resistant security bolts.

Installation

The access cover shall be installed in accordance with the manufacturer's installation instructions and recommendations.

* delete as applicable

Rebate Dimensions For Class G

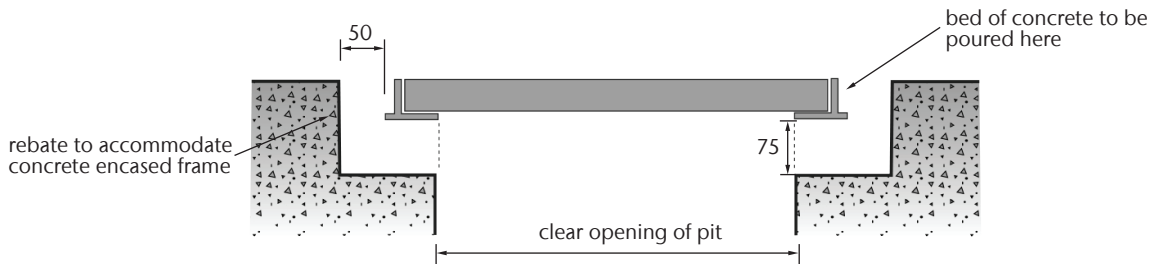

Due to the varying frame dimensions for different covers and decorative edging options, dimensions shown indicate the minimum amount of concrete required around the frame.

Full details at www.acoaccess.com.au/product-support/installation-guidance/

Concrete of a minimum strength of 32MPa and minimum aggregate of 12mm is recommended.



ACO Pty Ltd
Australia

Ph: 1300 765 226
www.acoaus.com.au

